

EHV Vanity Support Bracket

EH-LV-80

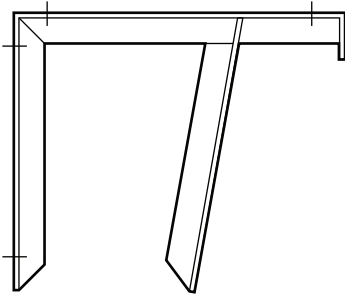

18" x 21 1/2"
counter depth up to 25"
weight capacity 450 lbs

EH-1818-LV

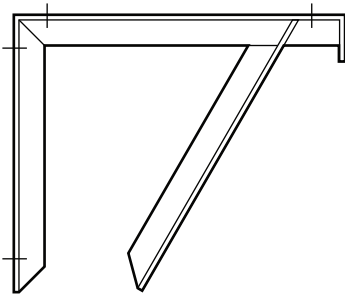

18" x 21 1/2"
counter depth up to 25"
weight capacity 450 lbs

Weight capacity is based on evenly distributed static loads

Parts included:



Heavy-duty aluminum Rakks ADA-compliant Vanity Support Brackets
Standard 18 x 21 1/2", or custom size

Additionally, you will need:



1/4" x 2 1/2" screws
for mounting
to wall



Vanity skirt



Construction adhesive or screws for
countertop surface mounting
according to manufacturer's recommendation

Measuring tape
Pencil or painter's tape
Level

Stud finder
Drill driver + 5/32" bit

Acceptable mounting applications:

Blocking
Studs
Double studs
Metal studs

Four (4) secured screws per bracket for up to 48" bracket spacing.

For other mounting surfaces, contact your Rakks representative.

1

Mark out the location of your vanity support brackets.

Determine the height from the floor to the bottom of your **countertop** surface.

Use a laser level, chalk line or tape measure and pencil to mark a level plane on the wall surface.

Slide the stud finder along this line and mark the exact center of each **stud** where a vanity bracket will be installed.

Hold the **bracket** against the wall at the stud location, ensuring that the center of the bracket is at the center of the stud.

Use a level to be sure the bracket is vertical, then mark the mounting holes.

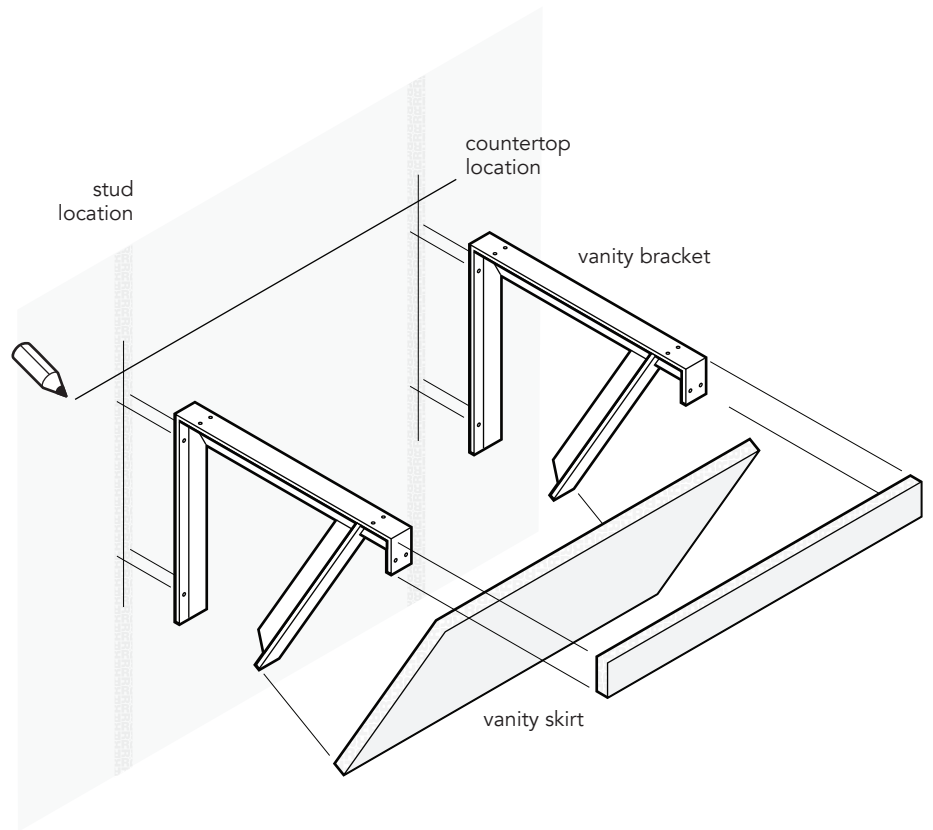

2

Secure the brackets.

Place the bracket aside. Use a $\frac{5}{32}$ " drill bit to drill pilot holes at a slight inward angle (**toeing**). This will ensure that all screws are fully engaged.

Note: The live load capacity per bracket is reduced if you are installing into metal studs or have only 2 secured screws per bracket. Contact your Rakks representative for more information.

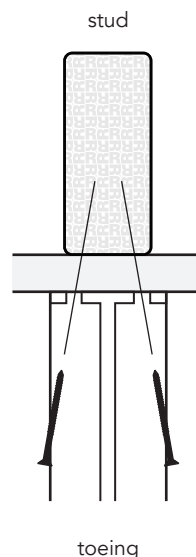

3

Install the vanity.

Refer to the manufacturers' instructions for installing the basin and counter. The brackets have 4 holes for securing the **skirt** from behind.