

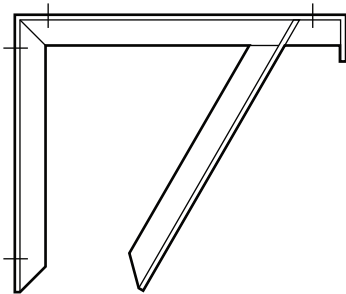

# EHV Vanity Support Bracket

EH-1818-LV



18" x 21 1/2"  
counter depth up to 24"  
weight capacity 450 lbs

Weight capacity is based on evenly  
distributed static loads

## Parts included:



**Heavy-duty aluminum Rakks ADA-compliant  
Vanity Support Brackets**  
Standard 18 x 21 1/2", or custom size



**Removable 3/4" pine strips on front faces**  
for mounting laminated or solid surface panels

## Additionally, you will need:



**1/4" x 2 1/2" screws**  
for mounting  
to wall

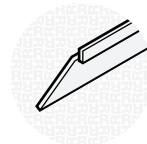

**Vanity skirt**



**Construction adhesive or screws for  
countertop surface mounting**  
according to manufacturer's recommendation

Measuring tape  
Pencil or painter's tape  
Level

Stud finder  
Drill driver + 5/32" bit

## Acceptable mounting applications:

Blocking  
Studs  
Double studs  
Metal studs

Four (4) secured screws per bracket for up to 48" bracket spacing.

**For other mounting surfaces, contact your Rakks representative.**

### 1

#### Mark out the location of your vanity support brackets.

Determine the height from the floor to the bottom of your **countertop** surface.

Use a laser level, chalk line or tape measure and pencil to mark a level plane on the wall surface.

Slide the stud finder along this line and mark the exact center of each **stud** where a vanity bracket will be installed.

Hold the **bracket** against the wall at the stud location, ensuring that the center of the bracket is at the center of the stud.

Use a level to be sure the bracket is vertical, then mark the mounting holes.

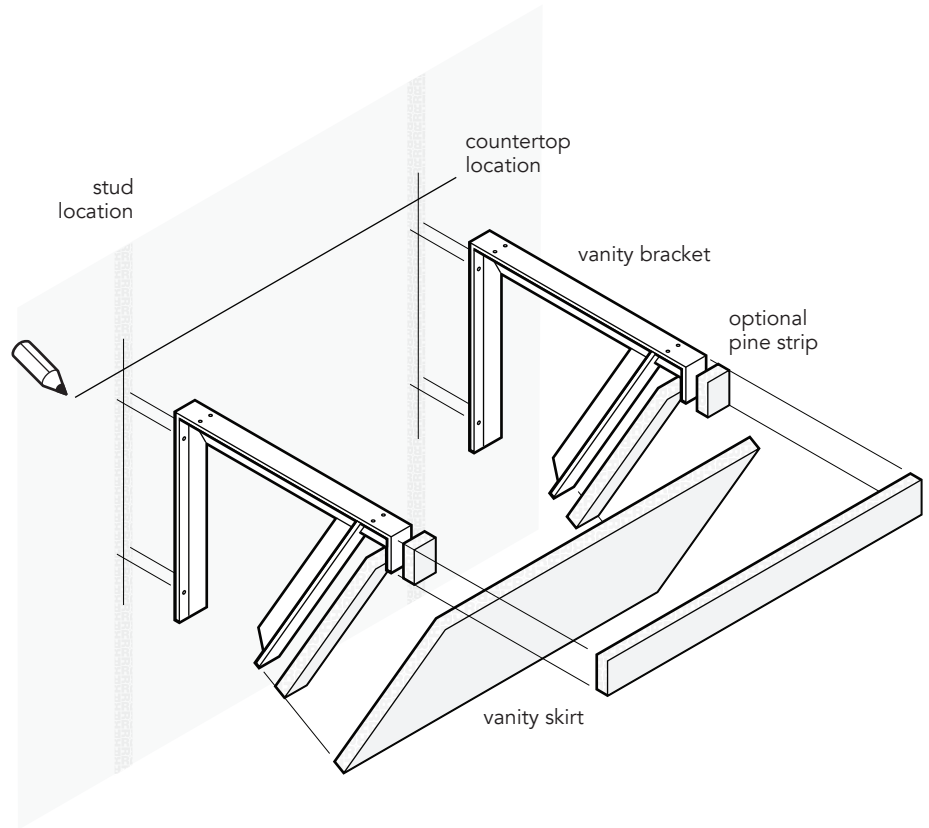

### 2

#### Secure the brackets.

Place the bracket aside. Use a  $\frac{5}{32}$ " drill bit to drill pilot holes at a slight inward angle (**toeing**). This will ensure that all screws are fully engaged.

**Note:** The live load capacity per bracket is reduced if you are installing into metal studs or have only 2 secured screws per bracket. Contact your Rakks representative for more information.

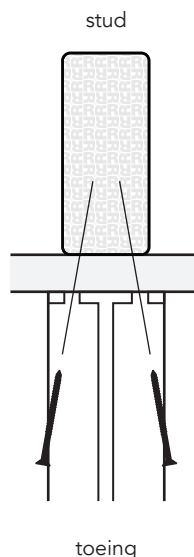

### 3

#### Install the vanity.

Refer to the manufacturers' instructions for installing the basin and counter. The brackets have 4 holes for securing the **skirt** from behind, or you can screw the skirt into the **pine strips**.