



EH Surface-mounted Bench Bracket

Parts included:



EHB-1416

Rakks EH surface-mounted bench brackets

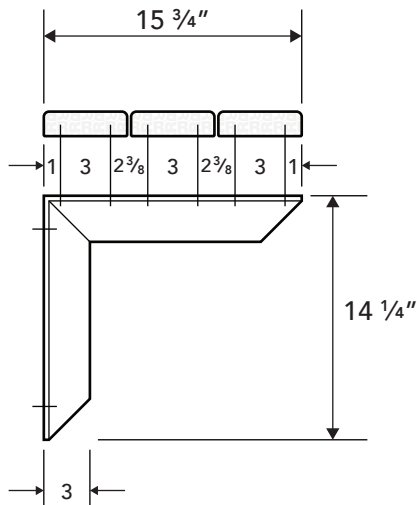

Additionally, you will need:



#14 × 2½" Philips head screws
for mounting to wall

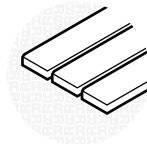

5" wooden planking or
solid top



Hardware to secure
your benchtop surface
according to manufacturer's recommendation

Measuring tape
Pencil or painter's tape
Level

Stud finder
Drill driver + 5/32" bit

Acceptable mounting applications:

Blocking
Double studs
Metal studs

Four (4) secured screws per bracket for up to 32" bracket spacing.

For other mounting surfaces, contact your Rakks representative.

EH Surface-mounted Bench Bracket

1

Mark out the location of your bench brackets.

Determine the height from the floor to the bottom of your **benchtop** surface.

Use a laser level, chalk line or tape measure and pencil to mark a level plane on the wall surface.

Slide the stud finder along this line and mark the exact center of each **stud** where a bench bracket will be installed.

Hold the bracket against the wall at the stud location, ensuring that the center of the bracket is at the center of the stud.

Use a level to be sure the bracket is vertical, then mark the mounting holes.

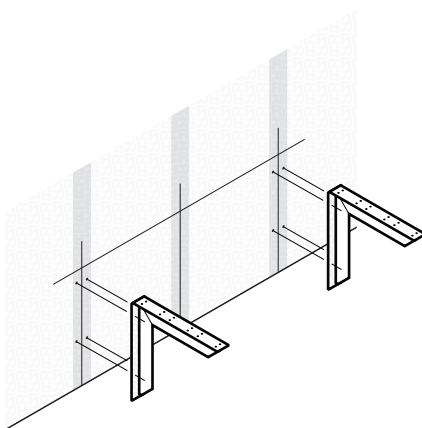

2

Drill pilot holes for the screws.

Place the bracket aside. Use a $\frac{5}{32}$ " drill bit to drill pilot holes in wood blocking.

If you have to install on wall studs, toeing is necessary. Drill the pilot holes at a slight inward angle, this will ensure that all screws are fully engaged.

Note: Keep in mind that the bracket span should be a maximum of 32" on center with 4 engaged screws.

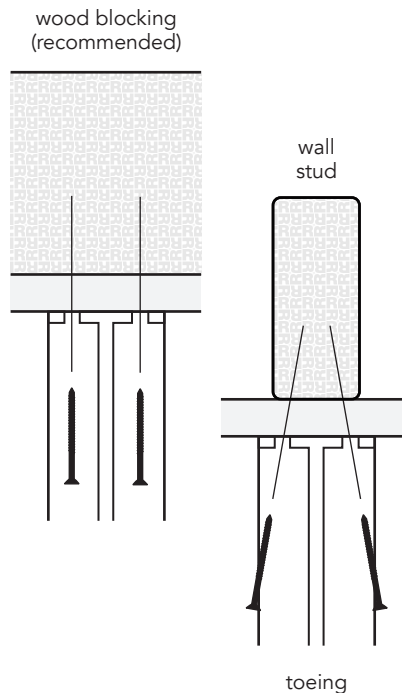

3

Secure the brackets.

Set the bracket in place and install the top mounting screw along the angle of your pilot hole.

Tighten until snug, then align the bracket vertically and install the bottom mounting screw. Install the remaining screws into their pilot holes.

Locate your next counter bracket mark along the level plane.

If necessary, use shims under the benchtop surface or between the bracket and the wall surface to achieve the desired level or pitch.

The holes in the bracket are spaced for 5" x 1" wooden planks. Pre-drill pilot holes. For true 1" planks, use 1" pan head screws and #10 washers. Ensure that the screw will end at least $\frac{3}{16}$ " below the surface.

If the seat is on an exterior wall, use appropriate weatherproof hardware and materials for the flat surface.

